

ENTRANCE HALLWAY External door, built in cupboard with space and plumbing for washing machine (piping available to move to kitchen), door to bedrooms, bathroom and open plan lounge/diner/kitchen, laminate oak wood flooring.

BATHROOM Obscured double glazed window to front aspect, three piece suite comprising panel enclosed bath with shower over, low level w.c, wash hand basin, partly tiled walls, towel rail.

BEDROOM ONE 13' 10" max x 10' 0" (4.23m x 3.07m) Full length double glazed window to rear aspect, radiator, the room currently fits a super king bed, double built in wardrobe.

BEDROOM TWO 12' 5" x 10' 3" (3.79m x 3.14m) Full length double glazed window to rear aspect, radiator, laminate oak wood flooring.

OPEN PLAN LOUNGE/DINER/KITCHEN 22' 8" x 16' 6" (6.92m x 5.05m) Full length double glazed window to side aspect, double glazed window to rear aspect, door to balcony, laminate oak wood flooring, two radiators.

KITCHEN AREA Range of matching wall and base units with inset one and a half bowl sink unit, integrated Smeg fridge/freezer, integrated Smeg dishwasher, integrated eye level Smeg oven and microwave, four ring ceramic Smeg hob and Electrolux extractor hood over.

OUTSIDE There is an allocated parking space within a gated car park and also offering visitor parking.





Ground Floor

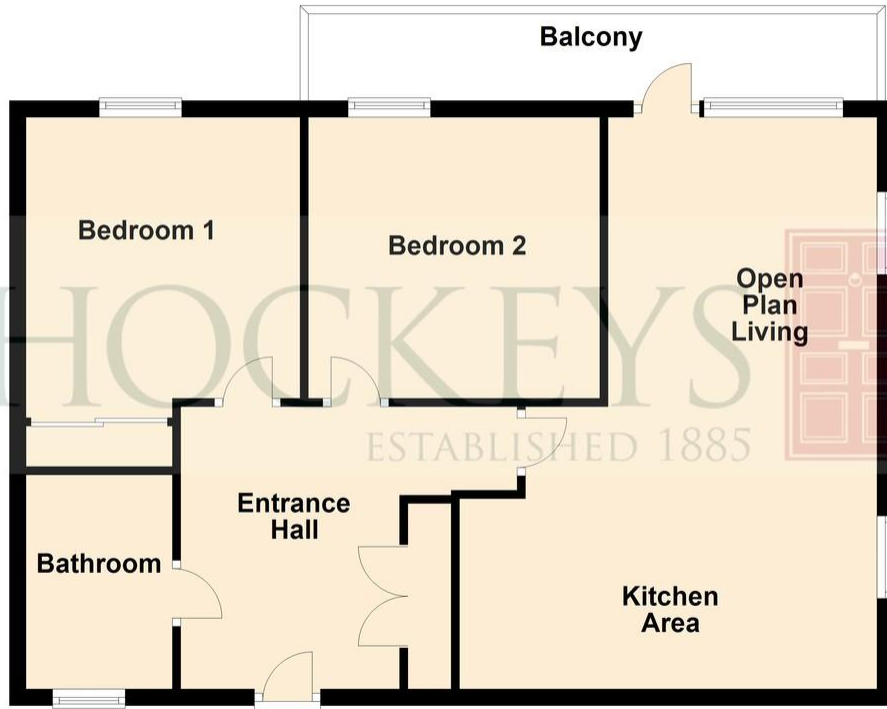

Addenbrookes Road, Trumpington

IMPORTANT: Hockeys (Cambridge) Ltd for themselves and for the vendors or lessors of this property whose agents they are give notice that the particulars are produced in good faith and are set out as a general guide only and do not constitute any part of a contract and no person in the employment of Hockeys (Cambridge) Ltd has any authority to make or give any representation or warranty in relation to this property .

10 Mill Road CB1 2AD
Telephone: 01223 356054
Email: cambridge@hockeys.co.uk

www.hockeys.co.uk

HOCKEYS
ESTABLISHED 1885





Addenbrookes Road, Trumpington,
Cambridge, CB2 9BA

£335,000 Leasehold

A two-bedroom apartment that is situated within Trumpington and a mere 1.5 miles away from Addenbrookes Hospital and 2 miles back into Cambridge Centre. This property has been finished to a fantastic standard throughout with a recently fitted kitchen, double aspect living room/diner and it's own balcony area to the rear.



HOCKEYS
ESTABLISHED 1885

