

LIVING ROOM 11' 1" x 10' 4" (3.40m x 3.17m) Wooden glass panelled external door, single glazed wooden window to rear aspect overlooking the rear garden, single glazed wooden box bay window to side aspect, radiator, stairs rising to first floor, opening to kitchen.



KITCHEN 7' 7" x 6' 10" (2.32m x 2.10m) Single glazed wooden window to rear aspect overlooking the rear garden, range of matching base and wall mounted units, built in electric cooker with hob and extractor hood over. Stainless steel sink unit with drainer, tiled splash backs, space and plumbing for washing machine, space for fridge/freezer, wall mounted gas boiler, under stairs storage area.

FIRST FLOOR LANDING Loft access, radiator, door to bedroom and bathroom.



BEDROOM 11' 2" x 10' 8" (3.42m x 3.27m) Single glazed wooden windows to rear and side aspect, radiator, over stairs storage cupboard.

BATHROOM Single glazed wooden window to rear aspect, three piece suite comprising low level w.c, panel enclosed bath with shower over, tiled splash backs, pedestal wash hand basin, heated towel rail.



OUTSIDE To the front of the property there is shingle area with picket fence surround and pathway leading to the front door and rear garden. The rear garden is recently landscaped, laid to Indian sandstone with patio area, shingle area and all fully enclosed. There is an off road parking space.





Ground Floor



First Floor

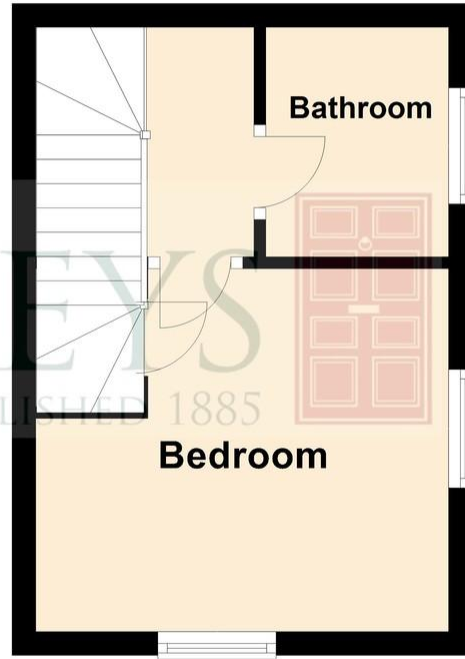

IMPORTANT: Hockeys (Cambridge) Ltd for themselves and for the vendors or lessors of this property whose agents they are give notice that the particulars are produced in good faith and are set out as a general guide only and do not constitute any part of a contract and no person in the employment of Hockeys (Cambridge) Ltd has any authority to make or give any representation or warranty in relation to this property .

10 Mill Road CB1 2AD
Telephone: 01223 356054
Email: cambridge@hockeys.co.uk

www.hockeys.co.uk

HOCKEYS
ESTABLISHED 1885





243 The Rowans, Milton, Cambridge,
CB24 6ZA

£235,000 Freehold

This pleasant one-bedroom home on The Rowans in Milton is situated 1.5 miles from Cambridge Science Park, making it just under a 10-minute cycle also to the Cambridge North Station. This property has also previously been rented out for £875PCM, so a great return for investors looking for properties throughout Cambridgeshire.



HOCKEYS
ESTABLISHED 1885

