

ENTRANCE HALLWAY Double glazed external door, built in cupboard, wall mounted electric heater, laminate wood flooring, doors to bedrooms, bathroom and open plan living space.

BEDROOM ONE 16' 4" x 8' 11" (4.99m x 2.73m) Double glazed window to front aspect, wall mounted electric heater, laminate wood flooring.

BEDROOM TWO 12' 7" x 9' 9" (3.86m x 2.98m) Double glazed window to front aspect, wall mounted electric heater, laminate wood flooring.

BATHROOM three piece suite comprising panel enclosed bath with shower over, tiled surround, pedestal wash hand basin with tiled splashback, low level w.c, extractor fan, wall mounted heated towel rail.

OPEN PLAN KITCHEN/DINER/LIVING ROOM

KITCHEN/DINER 15' 0" x 7' 1" (4.59m x 2.17m) Double glazed window to rear aspect, range of matching base and wall mounted units with worksurfaces over, inset stainless steel sink unit with drainer, freestanding electric cooker with four ring electric hob and Bosch extractor hood over, tile effect vinyl flooring. Space and plumbing for washing machine, integrated fridge/freezer, breakfast bar, opening to living room space.

LIVING ROOM 13' 6" x 13' 1" (4.12m x 3.99m) Double glazed door to balcony, two wall mounted electric heaters, coving, laminate wood flooring.

BALCONY 9' 4" x 4' 10" (2.86m x 1.48m) Part timber construction overlooking Glenalmond Avenue, an ideal space for seating.

OUTSIDE There is permit parking to the front of the property, a car park providing parking and a secure bike store.





Floor Plan

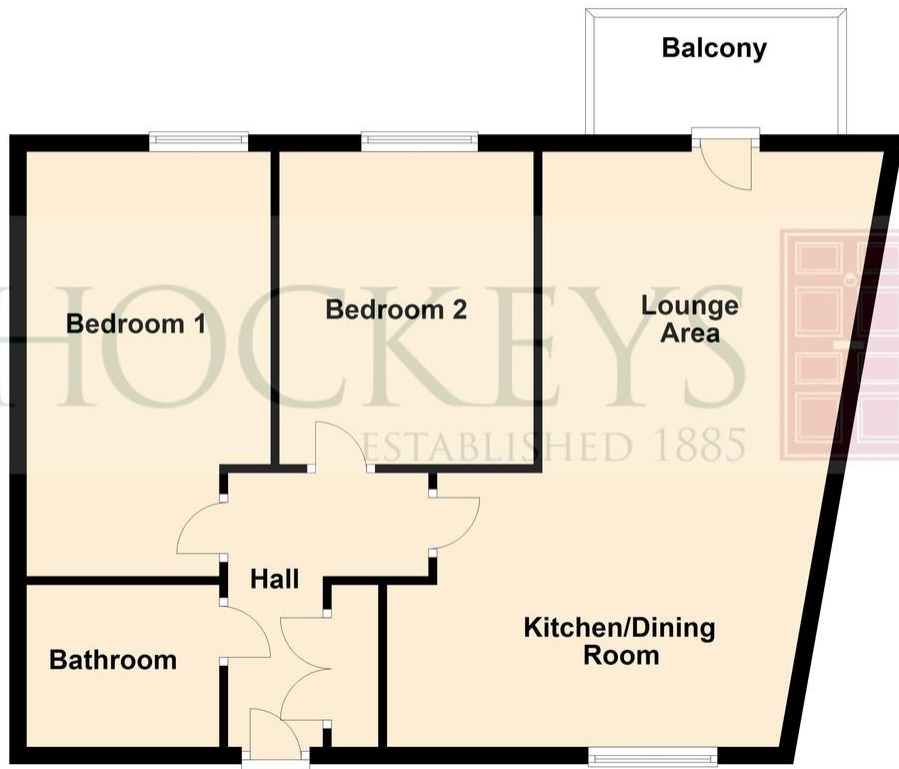

IMPORTANT: Hockeys (Cambridge) Ltd for themselves and for the vendors or lessors of this property whose agents they are give notice that the particulars are produced in good faith and are set out as a general guide only and do not constitute any part of a contract and no person in the employment of Hockeys (Cambridge) Ltd has any authority to make or give any representation or warranty in relation to this property .

10 Mill Road CB1 2AD
Telephone: 01223 356054
Email: cambridge@hockeys.co.uk

www.hockeys.co.uk

HOCKEYS
ESTABLISHED 1885





226 Glenalmond Avenue, Cambridge,
CB2 8DS

Shared Ownership £120,000 Leasehold

A two-bedroom top floor apartment which is situated just a ten-minute walk from Cambridge station, allowing for easy access into London and has been finished to a great standard throughout. The property is being sold as a 30% shared ownership with the potential to own 100% along with no onward chain.



HOCKEYS
ESTABLISHED 1885

