

ENTRANCE HALLWAY Wooden external door, airing cupboard, built in storage cupboards, loft access, coving, wood flooring, doors to bedrooms, bathroom, kitchen and lounge/diner.

BEDROOM ONE 11' 10" x 10' 11" (3.63m x 3.34m) Double glazed windows to side aspect, coving, radiator, built in wardrobes and drawers.

BEDROOM TWO 11' 10" x 8' 8" (3.62m x 2.66m) Two double glazed windows to side aspect, radiator, coving.

BATHROOM Double glazed obscured window to side aspect, coving, three piece suite comprising low level w.c, wash hand basin with vanity cabinet under and tiled splash back, panel enclosed bath with electric shower over and tiled surround.

KITCHEN 8' 10" x 7' 6" (2.70m x 2.29m) Double glazed windows to side aspect, range of matching base and wall mounted units with worksurfaces over, inset one and a half bowl sink unit with drainer, space and plumbing for washing machine, built in oven, four ring electric hob with extractor hood over, space for fridge/freezer, coving.

LOUNGE/DINER

LOUNGE AREA 15' 7" x 14' 4" (4.77m x 4.38m) Double glazed windows to side and rear aspect, radiator, coving.

DINING AREA 9' 10" x 8' 0" (3.00m x 2.45m) Double glazed windows to side aspect, radiator, coving, serving hatch to kitchen.

OUTSIDE The property is surrounded by communal greenery with communal parking area and garage.

AGENTS NOTE Service charge: £62.50 per month for the flat and £11.67 per month for the garage.





Floor Plan

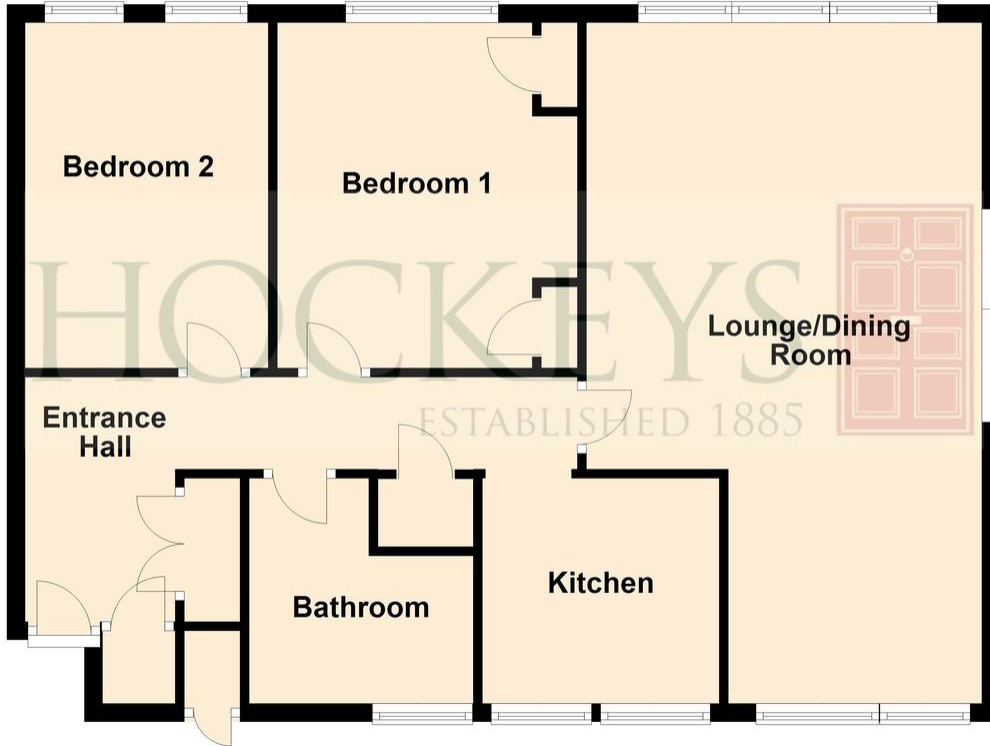

IMPORTANT: Hockeys (Cambridge) Ltd for themselves and for the vendors or lessors of this property whose agents they are give notice that the particulars are produced in good faith and are set out as a general guide only and do not constitute any part of a contract and no person in the employment of Hockeys (Cambridge) Ltd has any authority to make or give any representation or warranty in relation to this property .

10 Mill Road CB1 2AD
Telephone: 01223 356054
Email: cambridge@hockeys.co.uk

www.hockeys.co.uk

HOCKEYS
ESTABLISHED 1885





10 Kensington Court , Quanton Close,
Cambridge, CB5 8LS

£245,000 Share of Freehold

A large two-bedroom, top floor apartment with bags of potential to be improved, with an open plan living room/diner that pours natural light in through multiple windows and a garage with a communal car park. The property is situated within Barnwell, close to local amenities, Schools and is only two miles from the Cambridge Train Station.



HOCKEYS
ESTABLISHED 1885

