

ENTRANCE HALL Double glazed door to entrance hall, two storage cupboards, doors off to kitchen/diner and living room, stairs to first floor, door to rear garden, radiator, wood effect laminate flooring.

KITCHEN/DINER 13' 8" x 11' 2" (4.17m x 3.42m) Double glazed window to front, range of wall and floor mounted base units with space for American style fridge/freezer, integrated washer-dryer and dishwasher, electric cooker with four ring induction hob and extractor over, wooden worktop surfaces, stainless steel sink unit, storage cupboard under the stairs and further storage cupboard, tiled flooring.

LIVING AREA 14' 6" x 9' 10" (4.42m x 3.02m) Double glazed window to rear, wall mounted lights, stairs to first floor, radiator, wood effect laminate flooring.

FIRST FLOOR LANDING Loft access, doors to both bedrooms and family bathroom.

BEDROOM ONE 17' 10" x 10' 1" (5.46m x 3.08m) Double glazed window to rear overlooking garden, plenty of space for wardrobe storage, radiator, carpeted flooring.

BEDROOM TWO 10' 8" x 10' 6" (3.26m x 3.21m) Double glazed window to front, built-in wardrobe storage, radiator, carpeted flooring.

BATHROOM Two double glazed frosted windows to front, three piece suite comprising low level WC, pedestal wash basin, panelled bath with shower attachment over and rainfall shower head, wall mounted stainless steel towel rail, extractor, vinyl flooring.

OUTSIDE To the front of the property there is a lawned area with pathway to the front door.

The rear garden has two patio areas with a path leading to the rear access, a lawned area with planted gravel beds and mature tree borders and a brick built shed. There is one parking space and potential to rent a garage from the Council for £40 per month.





Ground Floor

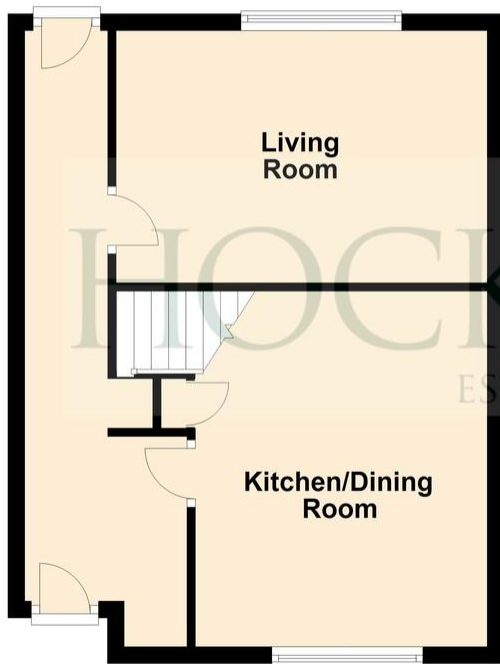

First Floor

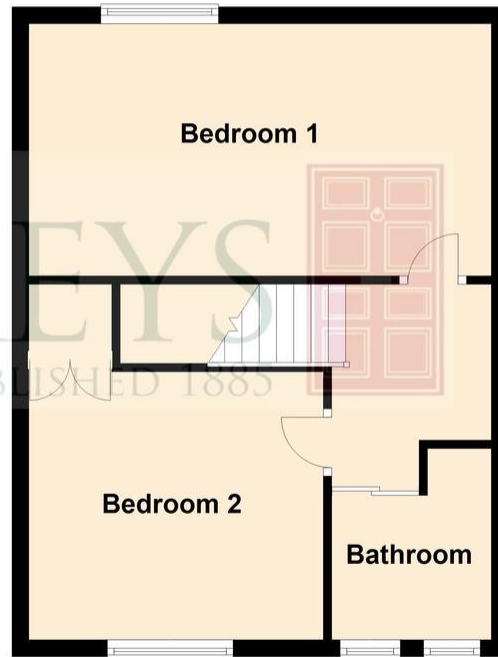

IMPORTANT: Hockeys (Willingham) Ltd for themselves and for the vendors or lessors of this property whose agents they are give notice that the particulars are produced in good faith and are set out as a general guide only and do not constitute any part of a contract and no person in the employment of Hockeys (Willingham) Ltd has any authority to make or give any representation or warranty in relation to this property .

10 Mill Road CB1 2AD
Telephone: 01223 356054
Email: cambridge@hockeys.co.uk

www.hockeys.co.uk

HOCKEYS
ESTABLISHED 1885





33 Teversham Drift,
Cambridge, CB1 3JZ

£325,000 Freehold

A spacious and immaculately presented two-bedroom mid-terrace property that is situated within Cherry Hinton on a popular residential development.

The property provides fantastic accommodation throughout with two large double bedrooms, some people within the development have actually converted their properties into a three-bedroom home, with a further living room and kitchen/diner.



HOCKEYS
ESTABLISHED 1885

