

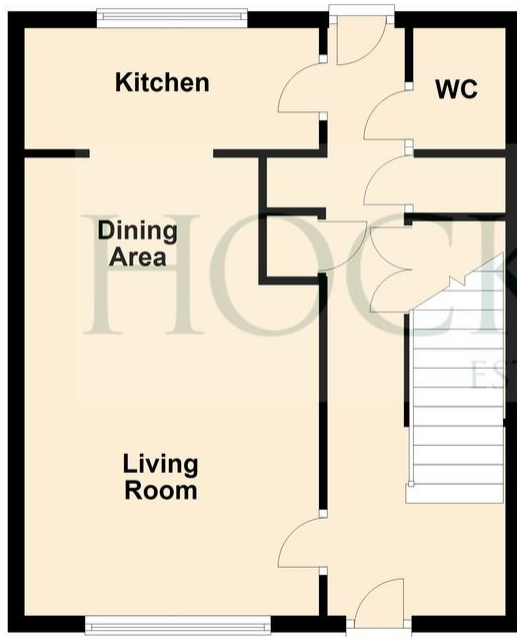



Ground Floor



First Floor

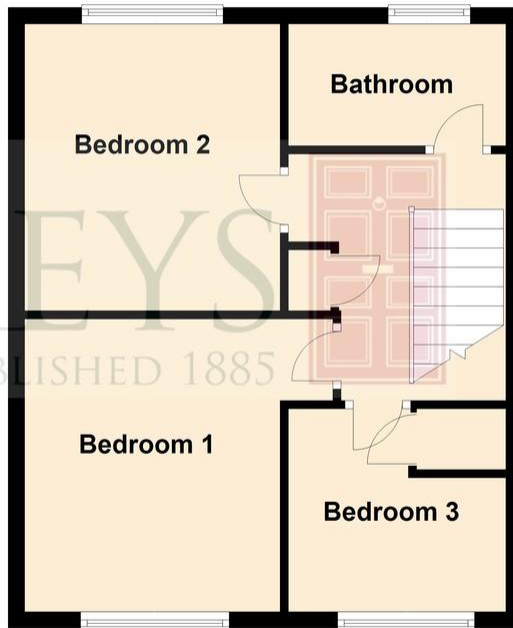

IMPORTANT: Hockeys (Willingham) Ltd for themselves and for the vendors or lessors of this property whose agents they are give notice that the particulars are produced in good faith and are set out as a general guide only and do not constitute any part of a contract and no person in the employment of Hockeys (Willingham) Ltd has any authority to make or give any representation or warranty in relation to this property .

10 Mill Road CB1 2AD
Telephone: 01223 356054
Email: cambridge@hockeys.co.uk

www.hockeys.co.uk

HOCKEYS
ESTABLISHED 1885





35 Sheppard Way, Teversham,
Cambridge, CB1 9AX

£370,000 Freehold

This three bedroom terraced home is conveniently situated on the outskirts of Cambridge city centre within the well regarded village of Teversham and falls under the catchment area for the Bottisham Village College making it ideal for any family!. The accommodation comprises open plan living space downstairs with three bedrooms and a family bathroom on the first floor.



HOCKEYS
ESTABLISHED 1885

